



Fitting Instructions

TOWBAR **BM15A**
For **BMW 3 SERIES (1998-)**
Coupe Late 1999 -

MATERIALS

A	1	Cross Bar
C	1	Neck – with European facing to 94/20/EC A50-1
D	2	Side Arms
E	2	Captive M10 Nut Strap
F/G	1	Bumper Supports with captive bolts
H	2	M12 x 90mm Bolts and Nyloc Nuts
J	2	25mm O.D. Bush, 28mm Long
K	2	M12 x 40mm Bolts, 6 Nuts, 6 Lock Washers and 6 Flat Washers (30mm O.D.)
L	4	M10 x 30mm Bolts, Lock Washers and Flat Washers (20mm O.D.)
M	1	Electrical Plate
CB	2	M16 x 50mm Coupling Bolts, Nuts, Lock Washers

FITTING

1. Remove the boot floor covering, side trim, battery cover and bumper (6 M8 nuts inside boot against rear panel, remove mud flaps and 1 push-in clip and 1 steel clip around each wheel arch). Release lower edge bumper inner shell (8 push-in clips) to allow access to bumper support strut torx bolts, release the bumper support struts and discard- retain bolts. Cut a slot in lower edge of bumper as shown below.
2. Position Sidearms (D) inside boot at existing vertical holes in vehicle chassis rails (108mm ctrs). Insert captive Nut Strap (E) through access holes in rear panel and loosely secure to Sidearms (D) using Bolts (L).
3. Position Cross Bar (A) at existing holes in rear panel and loosely secure using only uppermost bolts (K) with flat Washers.
4. Loosely secure Bumper Support Arms (F & G) to bumper inner shell using original Bolts at (X) **ensuring they are fitted the correct way up - see sketch below** - secure bumper inner shell to bumper using original push-in clips. Refit bumper using Nuts (K) with Flat Washers (see Sketch).
5. Tighten all bolts ensuring correct alignment of bumper. Secure Neck (C) with Bushes (J) and Electrical Plate (M) using Bolts (H) to Cross Bar (A) and fully tighten.

Note: This towbar must be used with either a Witter Towball (part number Z1) or Class A50-1 or A50-X towball dimensionally conforming to A50-1 with a 'D' and 'S' value greater than or equal to that of the towbar, also for use with Removable Towball Unit – Witter Part No. **ZR2M002**.

Please refer to the vehicle specification for the trailer weight and nose limits, which **must be observed**.

Recommended torque settings: M8 - 27Nm, M10 - 53 Nm, M12 - 95 Nm, M14 - 150 Nm, M16 - 214 Nm

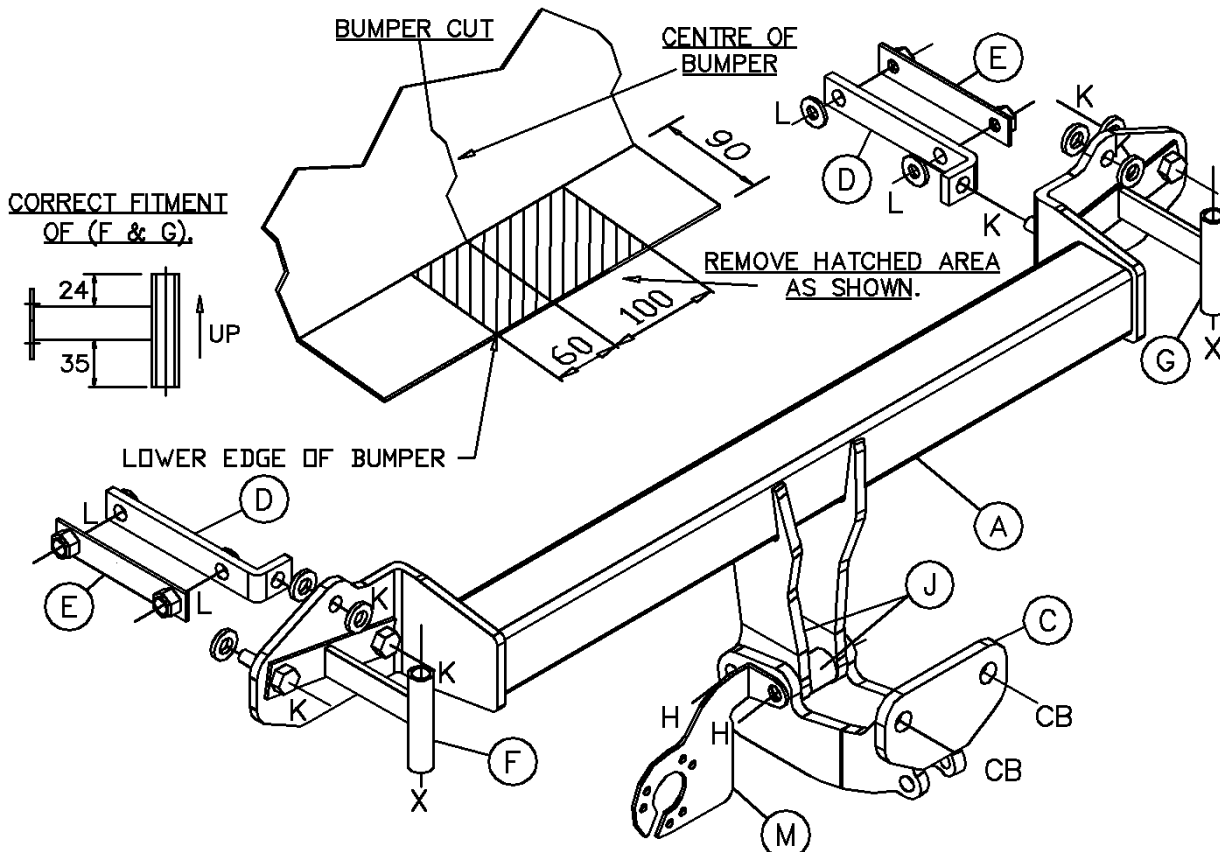

Fitting Instructions

Detachable Towball System

ZR2

MATERIALS

A Towball Receptor Unit



B Handle

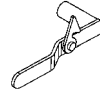

C Towball Neck

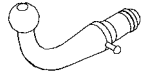

P Safety Chain Plate



W Weather Cover



S Towball Neck Bag

2 M12 x 75mm x 1.75 Bolts + Nylocs

FITTING OF TOWBALL RECEPTOR

1. Remove original bolts at (X) and Towbar Centre Part (If fitted).
2. Attach Towball Receptor Unit (A), Safety Chain Plate (P) and original Electrical Plate if removed, to Towbar Centre Plates using replacement Bolts and Nyloc Nuts.
3. Tighten Bolts to 96 Nm.

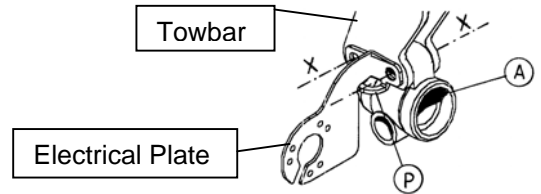

DETACHABLE OPERATION

1. Slide Handle (B) into Towball Receptor Unit (A) and keep orientated as shown.
2. Slide Towball Neck (C) into Towball Receptor Unit (A).
3. Rotate Towball Neck (C) anti-clockwise 180°.
4. Rotate Handle (B) clockwise until Spring Loaded Lock clips into position as shown.

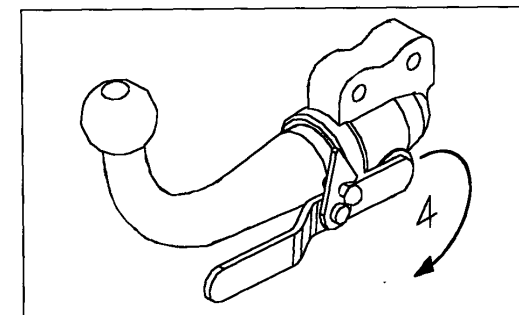
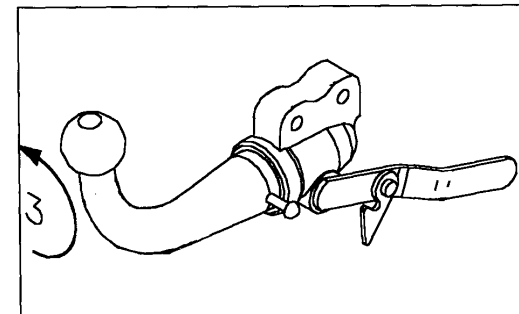
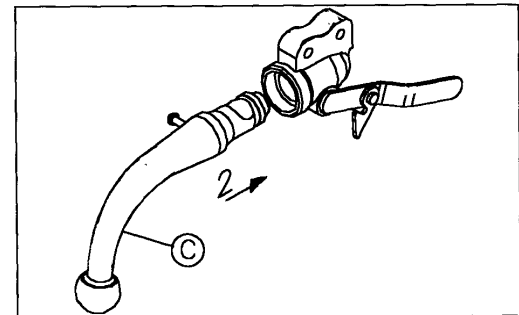
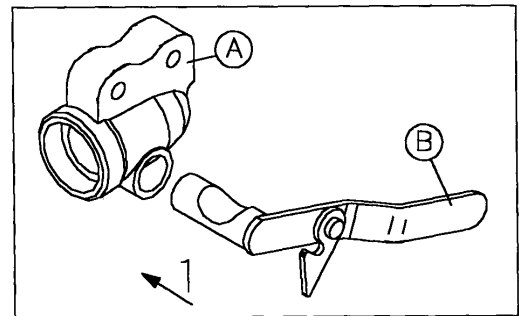

REMOVAL OF TOWBALL

Removal is a reverse of the above procedure. Place Handle (B) and Towball Neck (C) in bag provided. After removing Towball Neck (C) fit Weather Cover (W) to Towball Receptor Unit (A).