



Fitting Instructions

TOWBAR **BM31U**
For BMW Mini Clubman **For**
2007- **BM31 &**
BM31Q

MATERIALS

A	1	Cross Bar with European facing to 94/20/EC Class A50-1
B	8	M8 x 25mm Washers
D	1	M8 x 25 Bolt, Neoprene Washer and Nyloc Nut
E	1	Remove when not in use label
ZE	1	Electrical Plate Angle (ZEQ4)
ZP	1	Electrical Plate (ZEP4)

For use with either

BM31 Flange neck option (Bumper Cut as shown below) – ZF3004. *Note: This towbar must be used with either a Witter Towball (part number Z11 or Class A50-1 or A50-X towball dimensionally conforming to A50-1 with a 'D' and 'S' value greater than or equal to that of the towbar.*

BM31Q Detachable neck option (No Bumper Cut) – ZQ3002. Please refer to ZQ fitting instructions for installation.

FITTING

1. Remove bumper (1 wheel arch liner clip, 1 lower tip screw and 1 screw behind upper arch trim) each side and two lower edge screws. Unclip and pull bumper rearwards, and disconnect number plate lights.
2. Remove Crash Beam and retain existing fixings. It may be necessary to adjust the exhaust heat shield to suit
3. Loosely attach Towbar Crosstube (A) using existing fixings and washers (B). Tighten all Bolts
4. Cut Bumper if required - as shown below and refit.
5. Attach neck option, and fix label (E) to visible face on underside of bumper.

Please refer to the vehicle specification for the trailer weight and nose limits, which **must be observed**.
Recommended torque settings, 8.8 Grade: M8 - 27Nm, M12 - 95 Nm, M16 – 214Nm

BUMPER CUT - FLANGE NECK ONLY

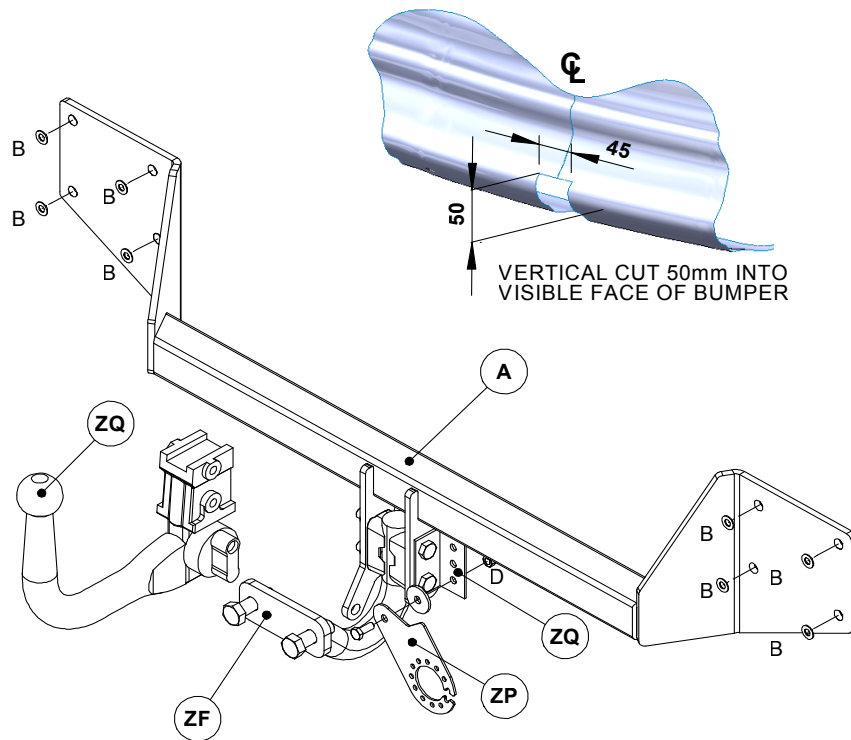

W0001BM31U-FIT\$010807080000